

DATA SHEET – DS05
JOISTED FLOORS
FIT FROM ABOVE PLATES

PRODUCT INFORMATION

Typical UFH kit items:

- UFH 16mm Pipe
- Fit from Above Plates
- 16mm Pipe Bend Supports
- Manifold Arms
- Manifold Pump / Mixer
- 1" Isolation Valves
- 16mm Manifold Pipe Connections
- Thermostat/s
- Wiring Centre
- Actuators (if more than one thermostat supplied)

FLOATING FLOOR SYSTEM DATA

- The UFH pipe is:
 - o 16x2mm 5-Layer PERT
- The pipe can be installed in:
 - o A serpentine 'up-and-down' pattern
- The pipe centres can be:
 - o 200mm
- Fit from Above Plate Size:
 - o 1,000mm x 395mm x 0.7mm
 - o 1,000mm x 595mm x 0.7mm

TYPICAL FIT FROM ABOVE SYSTEM SECTION:

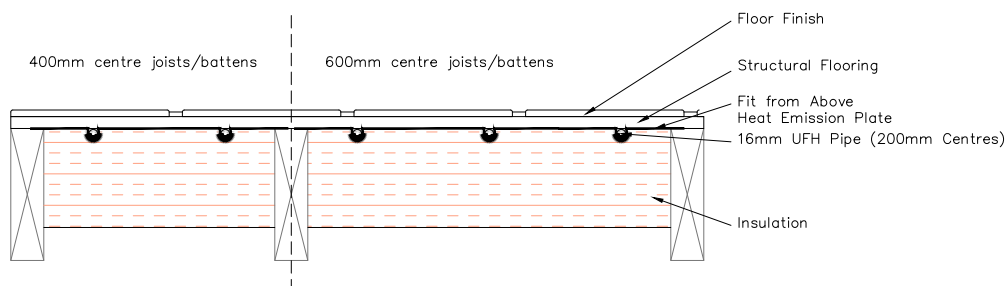

TYPICAL FIT FROM ABOVE SYSTEM HEAT

OUTPUTS:

FLOOR FINISH	TOG RATING	WATER FLOW TEMP	
		55 @ 200cc	45 @ 200cc
TILES	0.1 TOG	78W/m ²	53W/m ²
15mm ENGINEERED WOOD	1.0 TOG	61W/m ²	40W/m ²
CARPET	1.5 TOG	49W/m ²	33W/m ²